

LEGEND

- ⊙ In-Ceiling Speaker Location
- ⊙⊙ In-Ceiling Stereo Speaker Location
- ⊠ Cabinet Speaker Location
- ⊠ In-Wall Speaker Location
- ⊠ Invisible Speaker Location
- ⊠ L-C-R Speaker Location
- ⊠ Distributed Head Phone Jack
- ⊠ Multi-Media Location
- ⊠ Display Location
- ⊠ Computer Input Location
- ⊠ Control Location
- ⊠ TSTAT Location
- ⊠ Volume Control Location
- ⊠ Phone/Data Location
- ⊠ Data Location
- ⊠ Phone/Data Location; Floor
- ⊠ Intercom Location
- ⊠ WAP Location
- ⊠ Camera Location
- ⊠ Head-End Location
- ⊠ Panel Location
- ⊠ Demark Location

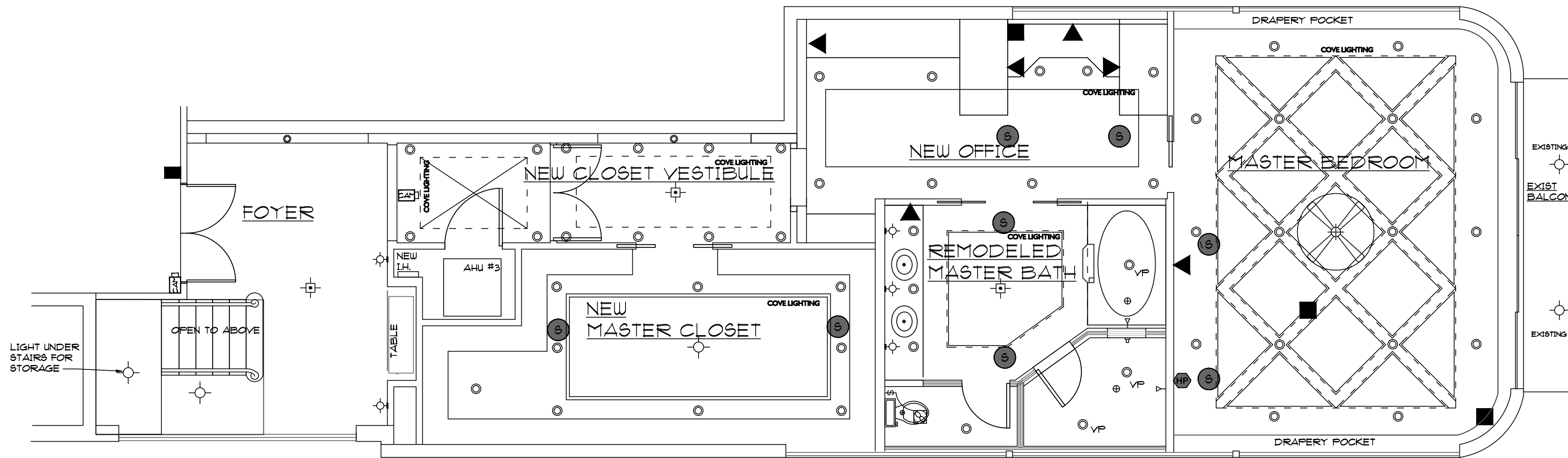

1ST FLOOR REFLECTED CEILING PLAN
1/4" = 1'-0"

ELECTRICAL SYMBOLS			
⊠	DUPLEX RECEPTACLE AT 8' AFF.	⊠	SWITCH SINGLE POLE
⊠	DUPLEX RECEPTACLE ARC FAULT INTERRUPTER	⊠	SWITCH THREE WAY
⊠	DUPLEX RECEPTACLE AT BASE	⊠	SWITCH FOUR WAY
⊠	DUPLEX RECEPTACLE AT 8' ADV. CENTER	⊠	SWITCH RECEPT
⊠	DUPLEX RECEPTACLE GROUND FAULT	⊠	SWITCH DIMMER
⊠	DUPLEX RECEPTACLE TOP REC. SWITCHED	⊠	SWITCH KEYED
⊠	DUPLEX RECEPTACLE WATERPROOF	⊠	SWITCH DISCONNECT
⊠	DUPLEX RECEPTACLE UNDER COUNTER	⊠	SECURITY KEY PAD
⊠	QUADPLEX RECEPT. AT 8' AFF.	⊠	GARAGE DOOR CONTROL PAD (FOR E.A. DOOR)
⊠	DEDICATED CIRCUIT 120V	⊠	GARAGE DOOR SENSOR BEAM
⊠	OUTLET FOR GARAGE DOOR OPENER	⊠	DOOR BELL
⊠	DIRECT WIRED MOTOR	⊠	INTERCOM AT 60" AFF.
⊠	220 V. RECEPTACLE AT 24" AFF.	⊠	INTERCOM BASE STATION
⊠	DUPLEX RECEPTACLE FLUSH IN FLOOR	⊠	PRE-WIRED TELEVISION CABLE SATELLITE JACK
⊠	JUNCTION BOX	⊠	CHIME BOX
⊠	TELEPHONE OUTLET AT 8' AFF.	⊠	TELEPHONE OUTLET FLUSH IN FLOOR
⊠	INTERNET, CABLE MODEM AT 8' AFF.	⊠	SPEAKER IN GLS
⊠	HARD WIRED SMOKE ALARM	⊠	HYAC THERMOSTAT
⊠	SECURITY RECESSED WALL WASHER	⊠	THERMOSTAT/HUMIDISTAT
⊠	RECESSED WALL WASHER	⊠	EXHAUST FAN
⊠	INCANDESCENT LIGHT WALL MOUNTED	⊠	EXHAUST FAN W/ LIGHT
⊠	WALL SCONCE	⊠	PADDLE FAN W/ OR W/O LIGHT
⊠	TRACK LIGHT	⊠	INCANDESCENT LIGHT CLG. MOUNTED
⊠	FLUORESCENT LIGHT FIXTURE	⊠	GLOBE LIGHT
⊠	PIER MOUNTED LIGHT FIXTURE	⊠	KEYLESS LIGHT FIXTURE
⊠	EMERGENCY LIGHTS	⊠	CHANDLER
⊠	SECURITY, FLOOD LIGHTS		
⊠	MOTION SENSOR LIGHTS		
⊠	BREAKER PANEL		
⊠	PANEL, METER & DISC.		

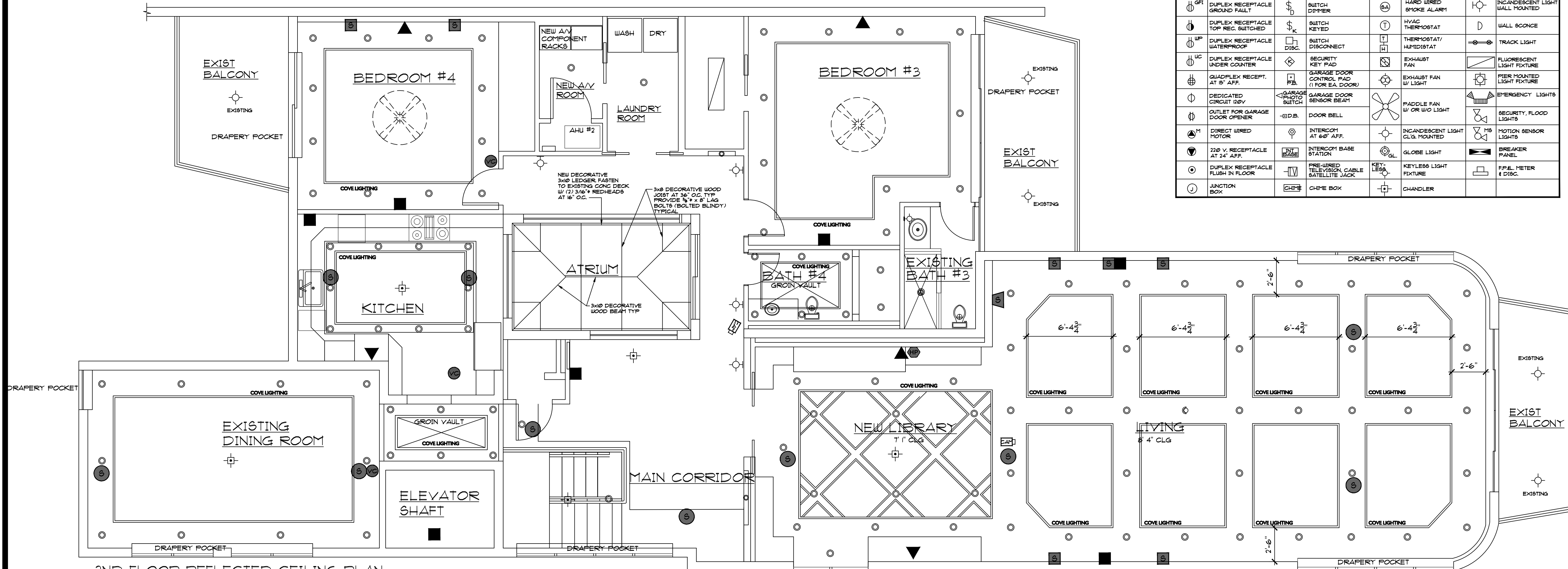

2ND FLOOR REFLECTED CEILING PLAN
1/4" = 1'-0"

Contractor shall check and verify all dimensions at the building site, and report any discrepancies to the Architect immediately.

PROJECT ADDRESS
YEARS RESIDENCE
2155 S. OCEAN BLVD
UNIT 10
DELRAY BEACH, FL

SHEET CONTENTS:
REFLECTED CEILING PLAN

DATE: 10-11-2010
SCALE: 1/4"=1'-0"
DRAWN BY: Andrew Slack
CHECKED BY:

AMES BENNETT & ASSOCIATES ARCHITECTURE
OF PALM BEACH, FLORIDA

SHEET NO.
5.3
AD3 OF AD3 SHEETS

JOB NO.
10-107

This document has been prepared by, or under the responsible supervision of

Ames Bennett, AIA, NCARB
Registered Architect
Florida # AR2001912

Ames Bennett & Associates, P.A.
217 Peruvian Avenue Suite 4
Palm Beach, Florida 33480
Florida #AAC001008

Office: (561) 655-0555
Fax: (561) 655-1232